

**3.01. Schweißbogen**

**3.01. отвод под сварку**

Art.-Nr. 32200-								AISI 304L-1.4307				AISI 316L-1.4404			
DN	A	B	C	D	E	Gew.		Art.-Nr.	Preis	Art.-Nr.	Preis	Art.-Nr.	Preis	Art.-Nr.	Preis
mm	mm	mm	mm	mm	mm	kg		poliert	EUR	matt	EUR	poliert	EUR	matt	EUR
10	26,0	9,0	12,0	26,0		0,010		-0101		-0102		-0103		-0104	
15	35,0	15,0	18,0	35,0		0,030		-0151		-0152		-0153		-0154	
20	40,0	19,0	22,0	40,0		0,040		-0201		-0202		-0203		-0204	
25	50,0	25,0	28,0	50,0		0,070		-0251		-0252		-0253		-0254	
32	55,0	31,0	34,0	55,0		0,100		-0321		-0322		-0323		-0324	
40	60,0	37,0	40,0	60,0		0,130		-0401		-0402		-0403		-0404	
50	70,0	49,0	52,0	70,0		0,200		-0501		-0502		-0503		-0504	
65	80,0	66,0	70,0	80,0		0,350		-0651		-0652		-0653		-0654	
80	90,0	81,0	85,0	90,0		0,540		-0801		-0802		-0803		-0804	
100	100,0	100,0	104,0	100,0		0,730		-1001		-1002		-1003		-1004	
125	187,5	125,0	129,0	187,5		1,780		-1251		-1252		-1253		-1254	
150	225,0	150,0	154,0	225,0		2,680		-1501		-1502		-1503		-1504	
200	300,0	200,0	204,0	300,0		4,720		-2001		-2002		-2003		-2004	

Schweißbogen  
DIN 90°

отвод под сварку  
90°

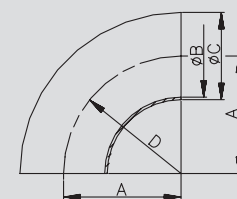

Art.-Nr. 32202-								AISI 304L-1.4307				AISI 316L-1.4404			
DN	A	B	C	D	E	Gew.		Art.-Nr.	Preis	Art.-Nr.	Preis	Art.-Nr.	Preis	Art.-Nr.	Preis
mm	mm	mm	mm	mm	mm	kg		poliert	EUR	matt	EUR	poliert	EUR	matt	EUR
10	17,0	9,0	12,0	26,0		0,008		-0101		-0102		-0103		-0104	
15	24,0	15,0	18,0	35,0		0,018		-0151		-0152		-0153		-0154	
20	27,0	19,0	22,0	40,0		0,025		-0201		-0202		-0203		-0204	
25	34,0	25,0	28,0	50,0		0,037		-0251		-0252		-0253		-0254	
32	37,0	31,0	34,0	55,0		0,050		-0321		-0322		-0323		-0324	
40	41,0	37,0	40,0	60,0		0,070		-0401		-0402		-0403		-0404	
50	48,0	49,0	52,0	70,0		0,100		-0501		-0502		-0503		-0504	
65	55,0	66,0	70,0	80,0		0,200		-0651		-0652		-0653		-0654	
80	62,0	81,0	85,0	90,0		0,285		-0801		-0802		-0803		-0804	
100	69,0	100,0	104,0	100,0		0,380		-1001		-1002		-1003		-1004	
125	131,0	125,0	129,0	187,5		0,890		-1251		-1252		-1253		-1254	
150	157,0	150,0	154,0	225,0		1,340		-1501		-1502		-1503		-1504	
200	209,0	200,0	204,0	300,0		2,360		-2001		-2002		-2003		-2004	

Schweißbogen  
DIN 45°

отвод под сварку  
DIN 45°

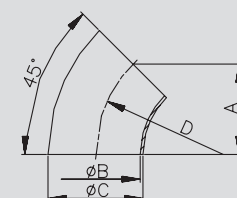

Art.-Nr. 32220-								AISI 304L-1.4307				AISI 316L-1.4404			
DN	A	B	C	D	E	Gew.		Art.-Nr.	Preis	Art.-Nr.	Preis	Art.-Nr.	Preis	Art.-Nr.	Preis
mm	mm	mm	mm	mm	mm	kg		poliert	EUR	matt	EUR	poliert	EUR	matt	EUR
10	26,0	10,0	13,0	26,0		0,010						-0103		-0104	
15	35,0	16,0	19,0	35,0		0,030						-0153		-0154	
20	40,0	20,0	23,0	40,0		0,040						-0203		-0204	
25	50,0	26,0	29,0	50,0		0,050		-0251		-0252		-0253		-0254	
32	55,0	32,0	35,0	55,0		0,080		-0321		-0322		-0323		-0324	
40	60,0	38,0	41,0	60,0		0,100		-0401		-0402		-0403		-0404	
50	70,0	50,0	53,0	70,0		0,170		-0501		-0502		-0503		-0504	

Schweißbogen  
DIN 11852-BS 90°

отвод под сварку  
DIN 11852-BS 90°

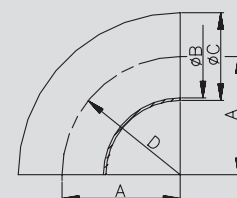

1  
2  
3  
4  
5  
6  
7  
8  
9  
10  
11

### 3.02. Schweißbogen

### 3.02. отвод под сварку

Schweißbogen  
DIN 11852-BS 45°

Art.-Nr. 32222-

AISI 304L-1.4307

AISI 316L-1.4404

отвод под сварку  
DIN 11852-BS 45°

DN	A mm	B mm	C mm	D mm	E mm	Gew. kg	AISI 304L-1.4307		AISI 316L-1.4404				
							Art.-Nr. poliert	Preis EUR	Art.-Nr. matt	Preis EUR	Art.-Nr. poliert	Preis EUR	Art.-Nr. matt
10	17,0	10,0	13,0	26,0		0,005				-0103		-0104	
15	23,0	16,0	19,0	35,0		0,015				-0153		-0154	
20	27,0	20,0	23,0	40,0		0,020				-0203		-0204	
25	34,0	26,0	29,0	50,0		0,025	-0251		-0252	-0253		-0254	
32	37,0	32,0	35,0	55,0		0,040	-0321		-0322	-0323		-0324	
40	41,0	38,0	41,0	60,0		0,050	-0401		-0402	-0403		-0404	
50	48,0	50,0	53,0	70,0		0,085	-0501		-0502	-0503		-0504	

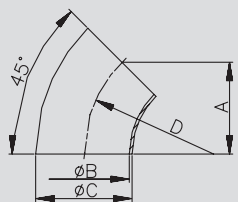

Schweißbogen  
Zoll 90°

Art.-Nr. 32601-

AISI 304L-1.4307

AISI 316L-1.4404

отвод под сварку  
дюйм 90°

DN	A mm	B mm	C mm	D mm	E mm	Gew. kg	AISI 304L-1.4307		AISI 316L-1.4404				
							Art.-Nr. poliert	Preis EUR	Art.-Nr. matt	Preis EUR	Art.-Nr. poliert	Preis EUR	Art.-Nr. matt
1"	27,5	22,9	25,4	27,5		0,085	-1001		-1002	-1003		-1004	
1,5"	45,0	35,1	38,1	45,0		0,240	-1121		-1122	-1123		-1124	
2"	67,5	47,8	50,8	67,5		0,380	-2001		-2002	-2003		-2004	
2,5"	82,5	60,2	63,5	82,5		0,570	-2121		-2122	-2123		-2124	
3"	95,0	72,8	76,1	95,0		1,075	-3001		-3002	-3003		-3004	
4"	133,5	97,4	101,6	133,5		1,240	-4001		-4002	-4003		-4004	

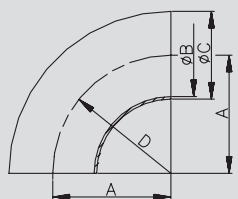

Schweißbogen  
Zoll 45°

Art.-Nr. 32621-

AISI 304L-1.4307

AISI 316L-1.4404

отвод под сварку  
дюйм 45°

DN	A mm	B mm	C mm	D mm	E mm	Gew. kg	AISI 304L-1.4307		AISI 316L-1.4404				
							Art.-Nr. poliert	Preis EUR	Art.-Nr. matt	Preis EUR	Art.-Nr. poliert	Preis EUR	Art.-Nr. matt
1"	18,0	22,9	25,4	27,5		0,040	-1001		-1002	-1003		-1004	
1,5"	30,0	35,1	38,1	45,0		0,120	-1121		-1122	-1123		-1124	
2"	46,0	47,8	50,8	67,5		0,190	-2001		-2002	-2003		-2004	
2,5"	57,0	60,2	63,5	82,5		0,290	-2121		-2122	-2123		-2124	
3"	65,5	72,8	76,1	95,0		0,540	-3001		-3002	-3003		-3004	
4"	93,5	97,4	101,6	133,5		0,620	-4001		-4002	-4003		-4004	

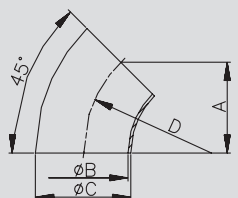

**3.03. Walz- und Schweißbogen**

**3.03. отвод под вальц и сварку**

**Art.-Nr. 33300-**

							AISI 304L-1.4307				AISI 316L-1.4404			
DN	A	B	C	D	E	Gew.	Art.-Nr.	Preis	Art.-Nr.	Preis	Art.-Nr.	Preis	Art.-Nr.	Preis
mm	mm	mm	mm	mm	mm	kg	poliert	EUR	matt	EUR	poliert	EUR	matt	EUR
10	38,0	12,0	9,0	12,0		0,025	-0101		-0102		-0103		-0104	
15	47,0	12,0	15,0	18,0		0,050	-0151		-0152		-0153		-0154	
20	52,0	12,0	19,0	22,0		0,070	-0201		-0202		-0203		-0204	
25	70,0	20,0	25,0	28,0		0,110	-0251		-0252		-0253		-0254	
32	78,0	23,0	31,0	34,0		0,150	-0321		-0322		-0323		-0324	
40	85,0	25,0	37,0	40,0		0,210	-0401		-0402		-0403		-0404	
50	97,0	27,0	49,0	52,0		0,280	-0501		-0502		-0503		-0504	
65	110,0	30,0	66,0	70,0		0,570	-0651		-0652		-0653		-0654	
80	118,0	28,0	81,0	85,0		0,790	-0801		-0802		-0803		-0804	
100	140,0	40,0	100,0	104,0		1,200	-1001		-1002		-1003		-1004	

**Walzbogen 90°**  
**отвод под вальцовку 90°**

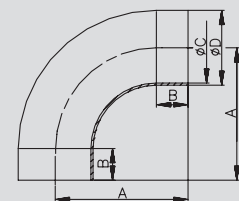

**Art.-Nr. 33306-**

							AISI 304L-1.4307				AISI 316L-1.4404			
DN	A	B	C	D	E	Gew.	Art.-Nr.	Preis	Art.-Nr.	Preis	Art.-Nr.	Preis	Art.-Nr.	Preis
mm	mm	mm	mm	mm	mm	kg	poliert	EUR	matt	EUR	poliert	EUR	matt	EUR
10	35,0	9,0	12,0	35,0		0,021					-0103		-0104	
15	50,0	15,0	18,0	50,0		0,048					-0153		-0154	
20	60,0	19,0	22,0	60,0		0,060	-0201		-0202		-0203		-0204	
25	65,0	25,0	28,0	65,0		0,100	-0251		-0252		-0253		-0254	
32	75,0	31,0	34,0	75,0		0,110	-0321		-0322		-0323		-0324	
40	95,0	37,0	40,0	95,0		0,190	-0401		-0402		-0403		-0404	
50	125,0	49,0	52,0	125,0		0,370	-0501		-0502		-0503		-0504	
65	160,0	66,0	70,0	160,0		0,780	-0651		-0652		-0653		-0654	
80	200,0	81,0	85,0	200,0		1,170	-0801		-0802		-0803		-0804	
100	250,0	100,0	104,0	250,0		1,820	-1001		-1002		-1003		-1004	
125	312,5	125,0	129,0	312,5		3,100	-1251		-1252		-1253		-1254	

**Schweißbogen 5D 90°**  
**отвод под сварку 5D 90°**

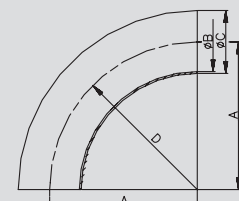

**Art.-Nr. 33320-**

							AISI 304L-1.4307				AISI 316L-1.4404			
DN	A	B	C	D	E	Gew.	Art.-Nr.	Preis	Art.-Nr.	Preis	Art.-Nr.	Preis	Art.-Nr.	Preis
mm	mm	mm	mm	mm	mm	kg	poliert	EUR	matt	EUR	poliert	EUR	matt	EUR
10	51,0	25,0	10,0	13,0		0,040	-0101		-0102		-0103		-0104	
15	60,0	25,0	16,0	19,0		0,070	-0151		-0152		-0153		-0154	
20	65,0	25,0	20,0	23,0		0,091	-0201		-0202		-0203		-0204	
25	90,0	40,0	26,0	29,0		0,160	-0251		-0252		-0253		-0254	
32	95,0	40,0	32,0	35,0		0,209	-0321		-0322		-0323		-0324	
40	100,0	40,0	38,0	41,0		0,254	-0401		-0402		-0403		-0404	
50	110,0	40,0	50,0	53,0		0,366	-0501		-0502		-0503		-0504	
65	120,0	40,0	66,0	70,0		0,701	-0651		-0652		-0653		-0654	
80	145,0	55,0	81,0	85,0		1,045	-0801		-0802		-0803		-0804	
100	155,0	55,0	100,0	104,0		1,363	-1001		-1002		-1003		-1004	
125	245,0	57,5	125,0	129,0		2,600	-1251		-1252		-1253		-1254	

**Schweißbogen DIN11852-BL 90°**  
**отвод под сварку DIN11852-BL 90°**

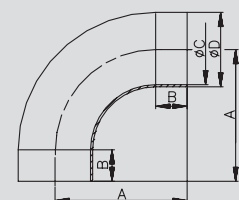

1  
2  
3  
4  
5  
6  
7  
8  
9  
10  
11

### 3.04. Schweiß- und Clampbogen

### 3.04. отвод под сварку и скобу

Schweißbogen  
5D Reihe 2 90°

Art.-Nr. 33326-

AISI 304/304L-1.4301/1.4307

AISI 316L-1.4404

отвод под сварку  
5D ряд 2 90°

DN	A	B	C	D	E	Gew.	AISI 304/304L-1.4301/1.4307		AISI 316L-1.4404		
							Art.-Nr.	Preis	Art.-Nr.	Preis	
mm	mm	mm	mm	mm	mm	kg	poliert	EUR	matt	EUR	
10	40,0	10,0	13,0	40,0		0,026				-0103	-0104
15	50,0	16,0	19,0	50,0		0,052				-0153	-0154
20	55,0	20,0	23,0	55,0		0,069	-0201	-0202		-0203	-0204
25	90,0	26,0	29,0	90,0		0,145	-0251	-0252		-0253	-0254
32	75,0	32,0	35,0	75,0		0,148	-0321	-0322		-0323	-0324
40	125,0	38,0	41,0	125,0		0,294	-0401	-0402		-0403	-0404
50	125,0	50,0	53,0	125,0		0,380	-0501	-0502		-0503	-0504

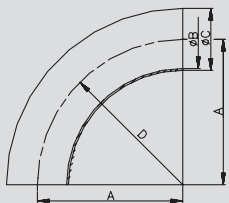

Bogen DIN CC 90°

Art.-Nr. 34400-

AISI 304/304L-1.4301/1.4307

AISI 316L-1.4404

Отвод DIN CC 90°

DN	A	B	C	D	E	Gew.	AISI 304/304L-1.4301/1.4307		AISI 316L-1.4404		
							Art.-Nr.	Preis	Art.-Nr.	Preis	
mm	mm	mm	mm	mm	mm	kg	poliert	EUR	matt	EUR	
10	44,0	10,0	0,0	26,0		0,080	-0101	-0102		-0103	-0104
15	53,0	16,0	0,0	35,0		0,100	-0151	-0152		-0153	-0154
20	58,0	20,0	0,0	40,0		0,120	-0201	-0202		-0203	-0204
25	63,0	26,0	0,0	50,0		0,190	-0251	-0252		-0253	-0254
32	68,0	32,0	0,0	55,0		0,240	-0321	-0322		-0323	-0324
40	73,0	38,0	0,0	60,0		0,260	-0401	-0402		-0403	-0404
50	83,0	50,0	0,0	70,0		0,310	-0501	-0502		-0503	-0504
65	93,0	66,0	0,0	80,0		0,600	-0651	-0652		-0653	-0654
80	103,0	81,0	0,0	90,0		1,000	-0801	-0802		-0803	-0804
100	113,0	100,0	0,0	100,0		1,610	-1001	-1002		-1003	-1004

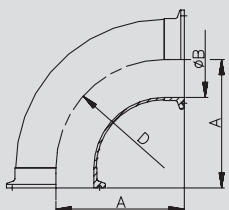

Bogen Zoll CC 90°

Art.-Nr. 34401-

AISI 304/304L-1.4301/1.4307

AISI 316L-1.4404

Отвод дюйм CC 90°

DN	A	B	C	D	E	Gew.	AISI 304/304L-1.4301/1.4307		AISI 316L-1.4404		
							Art.-Nr.	Preis	Art.-Nr.	Preis	
mm	mm	mm	mm	mm	mm	kg	poliert	EUR	matt	EUR	
1"	40,5	22,9	0,0	27,5		0,180	-1001	-1002		-1003	-1004
1,5"	58,0	35,1	0,0	45,0		0,270	-1121	-1122		-1123	-1124
2"	80,5	47,8	0,0	67,5		0,330	-2001	-2002		-2003	-2004
2,5"	95,5	60,5	0,0	82,5		0,490	-2121	-2122		-2123	-2124
3"	108,0	72,1	0,0	95,0		0,800	-3001	-3002		-3003	-3004
4"	146,5	97,6	0,0	133,5		1,500	-4001	-4002		-4003	-4004

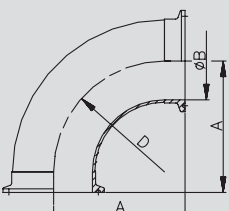

**3.05. Bogen mit Anschlüssen**

**3.05. Отвод с подключениями**

Art.-Nr. 35200-							AISI 304/304L-1.4301/1.4307				AISI 316L-1.4404			
DN	A	B	C	D	E	Gew.	Art.-Nr.	Preis	Art.-Nr.	Preis	Art.-Nr.	Preis	Art.-Nr.	Preis
mm	mm	mm	mm	mm	mm	kg	poliert	EUR	matt	EUR	poliert	EUR	matt	EUR
10	43,0	26,0	9,0	26,0	Rd28x1/8"	0,040	-0101		-0102		-0103		-0104	
15	52,0	35,0	15,0	35,0	Rd34x1/8"	0,070	-0151		-0152		-0153		-0154	
20	59,0	40,0	19,0	40,0	Rd44x1/6"	0,130	-0201		-0202		-0203		-0204	
25	72,0	50,0	25,0	50,0	Rd52x1/6"	0,170	-0251		-0252		-0253		-0254	
32	77,0	55,0	31,0	55,0	Rd58x1/6"	0,220	-0321		-0322		-0323		-0324	
40	82,0	60,0	37,0	60,0	Rd65x1/6"	0,250	-0401		-0402		-0403		-0404	
50	93,0	70,0	49,0	70,0	Rd78x1/6"	0,470	-0501		-0502		-0503		-0504	
65	105,0	80,0	66,0	80,0	Rd95x1/6"	0,710	-0651		-0652		-0653		-0654	
80	115,0	90,0	81,0	90,0	Rd110x1/4"	0,930	-0801		-0802		-0803		-0804	
100	130,0	100,0	100,0	100,0	Rd130x1/4"	1,250	-1001		-1002		-1003		-1004	
125	223,0	187,5	125,0	187,5	Rd160x1/4"	2,900	-1251		-1252		-1253		-1254	
150	265,0	225,0	150,0	225,0	Rd190x1/4"	4,280	-1501		-1502		-1503		-1504	

Rd: Rundgewinde  
Rd: Резьба круглая

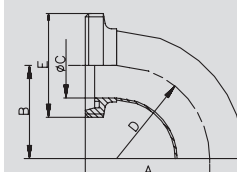

Art.-Nr. 35500-							AISI 304/304L-1.4301/1.4307				AISI 316L-1.4404			
DN	A	B	C	D	E	Gew.	Art.-Nr.	Preis	Art.-Nr.	Preis	Art.-Nr.	Preis	Art.-Nr.	Preis
mm	mm	mm	mm	mm	mm	kg	poliert	EUR	matt	EUR	poliert	EUR	matt	EUR
10	43,0	9,0	0,0	26,0	Rd28x1/8"	0,075	-0101		-0102		-0103		-0104	
15	52,0	15,0	0,0	35,0	Rd34x1/8"	0,120	-0151		-0152		-0153		-0154	
20	59,0	19,0	0,0	40,0	Rd44x1/6"	0,200	-0201		-0202		-0203		-0204	
25	72,0	25,0	0,0	50,0	Rd52x1/6"	0,245	-0251		-0252		-0253		-0254	
32	77,0	31,0	0,0	55,0	Rd58x1/6"	0,310	-0321		-0322		-0323		-0324	
40	82,0	37,0	0,0	60,0	Rd65x1/6"	0,400	-0401		-0402		-0403		-0404	
50	93,0	49,0	0,0	70,0	Rd78x1/6"	0,500	-0501		-0502		-0503		-0504	
65	105,0	66,0	0,0	80,0	Rd95x1/6"	0,900	-0651		-0652		-0653		-0654	
80	115,0	81,0	0,0	90,0	Rd110x1/4"	1,380	-0801		-0802		-0803		-0804	
100	130,0	100,0	0,0	100,0	Rd130x1/4"	2,320	-1001		-1002		-1003		-1004	
125	223,0	125,0	0,0	187,5	Rd160x1/4"	3,820	-1251		-1252		-1253		-1254	
150	265,0	150,0	0,0	225,0	Rd190x1/4"	5,840	-1501		-1502		-1503		-1504	

Rd: Rundgewinde  
Rd: Резьба круглая

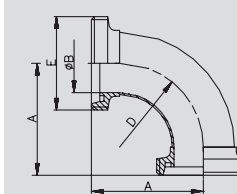

Art.-Nr. 35502-							AISI 304/304L-1.4301/1.4307				AISI 316L-1.4404			
DN	A	B	C	D	E	Gew.	Art.-Nr.	Preis	Art.-Nr.	Preis	Art.-Nr.	Preis	Art.-Nr.	Preis
mm	mm	mm	mm	mm	mm	kg	poliert	EUR	matt	EUR	poliert	EUR	matt	EUR
10	38,5	9,0	0,0	26,0		0,073	-0101		-0102		-0103		-0104	
15	44,0	15,0	0,0	35,0		0,104	-0151		-0152		-0153		-0154	
20	48,5	19,0	0,0	40,0		0,173	-0201		-0202		-0203		-0204	
25	59,0	25,0	0,0	50,0		0,250	-0251		-0252		-0253		-0254	
32	62,5	31,0	0,0	55,0		0,280	-0321		-0322		-0323		-0324	
40	66,0	37,0	0,0	60,0		0,340	-0401		-0402		-0403		-0404	
50	74,5	49,0	0,0	70,0		0,410	-0501		-0502		-0503		-0504	
65	83,5	66,0	0,0	80,0		0,700	-0651		-0652		-0653		-0654	
80	90,5	81,0	0,0	90,0		1,120	-0801		-0802		-0803		-0804	
100	102,0	100,0	0,0	100,0		1,730	-1001		-1002		-1003		-1004	
125	170,0	125,0	0,0	187,5		2,830	-1251		-1252		-1253		-1254	
150	202,0	150,0	0,0	225,0		4,480	-1501		-1502		-1503		-1504	

Preis auf Anfrage  
Цена по запросу

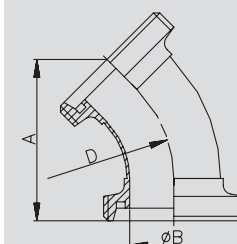

### 3.06. Bogen mit Anschlüssen

### 3.06. Отвод с подключениями

**Bogen KG 90°**

**Art.-Nr. 35600-**

AISI 304/304L-1.4301/1.4307

AISI 316L-1.4404

**Отвод ШП 90°**

DN	A	B	C	D	E	Gew.	Art.-Nr.	Preis	Art.-Nr.	Preis	Art.-Nr.	Preis	Art.-Nr.	Preis
mm	mm	mm	mm	mm	mm	kg	poliert	EUR	matt	EUR	poliert	EUR	matt	EUR
10	43,0	39,0	9,0	26,0	Rd28x1/8"	0,130	-0101		-0102		-0103		-0104	
15	52,0	48,0	15,0	35,0	Rd34x1/8"	0,200	-0151		-0152		-0153		-0154	
20	59,0	53,0	19,0	40,0	Rd44x1/6"	0,280	-0201		-0202		-0203		-0204	
25	72,0	65,0	25,0	50,0	Rd52x1/6"	0,400	-0251		-0252		-0253		-0254	
32	77,0	70,0	31,0	55,0	Rd58x1/6"	0,510	-0321		-0322		-0323		-0324	
40	82,0	75,0	37,0	60,0	Rd65x1/6"	0,630	-0401		-0402		-0403		-0404	
50	93,0	86,0	49,0	70,0	Rd78x1/6"	0,870	-0501		-0502		-0503		-0504	
65	105,0	97,0	66,0	80,0	Rd95x1/6"	1,440	-0651		-0652		-0653		-0654	
80	115,0	107,0	81,0	90,0	Rd110x1/4"	1,900	-0801		-0802		-0803		-0804	
100	130,0	120,0	100,0	100,0	Rd130x1/4"	2,610	-1001		-1002		-1003		-1004	
125	223,0	211,0	125,0	187,5	Rd160x1/4"	4,950	-1251		-1252		-1253		-1254	
150	265,0	252,0	150,0	225,0	Rd190x1/4"	7,250	-1501		-1502		-1503		-1504	

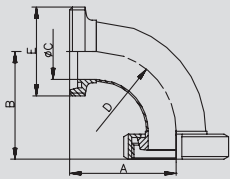

Rd: Rundgewinde  
Rd: Резьба круглая

**Bogen KG 45°**

**Art.-Nr. 35602-**

AISI 304/304L-1.4301/1.4307

AISI 316L-1.4404

**Отвод ШП 45°**

DN	A	B	C	D	E	Gew.	Art.-Nr.	Preis	Art.-Nr.	Preis	Art.-Nr.	Preis	Art.-Nr.	Preis
mm	mm	mm	mm	mm	mm	kg	poliert	EUR	matt	EUR	poliert	EUR	matt	EUR
10	38,5	9,0	0,0	26,0		0,090	-0101		-0102		-0103		-0104	
15	44,0	15,0	0,0	35,0		0,124	-0151		-0152		-0153		-0154	
20	48,5	19,0	0,0	40,0		0,215	-0201		-0202		-0203		-0204	
25	59,0	25,0	0,0	50,0		0,360	-0251		-0252		-0253		-0254	
32	62,5	31,0	0,0	55,0		0,430	-0321		-0322		-0323		-0324	
40	66,0	37,0	0,0	60,0		0,530	-0401		-0402		-0403		-0404	
50	74,5	50,0	0,0	70,0		0,560	-0501		-0502		-0503		-0504	
65	83,5	66,0	0,0	80,0		1,170	-0651		-0652		-0653		-0654	
80	90,5	81,0	0,0	90,0		1,700	-0801		-0802		-0803		-0804	
100	102,0	100,0	0,0	100,0		2,470	-1001		-1002		-1003		-1004	
125	170,0	125,0	0,0	187,5		3,960	-1251		-1252		-1253		-1254	
150	202,0	150,0	0,0	225,0		5,890	-1501		-1502		-1503		-1504	

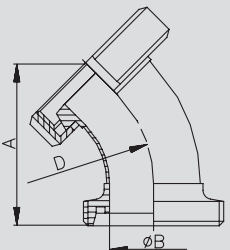

**Bogen KS 90°**

**Art.-Nr. 36200-**

AISI 304/304L-1.4301/1.4307

AISI 316L-1.4404

**Отвод ШС 90°**

DN	A	B	C	D	E	Gew.	Art.-Nr.	Preis	Art.-Nr.	Preis	Art.-Nr.	Preis	Art.-Nr.	Preis
mm	mm	mm	mm	mm	mm	kg	poliert	EUR	matt	EUR	poliert	EUR	matt	EUR
10	39,0	26,0	9,0	26,0		0,030	-0101		-0102		-0103		-0104	
15	48,0	35,0	15,0	35,0		0,050	-0151		-0152		-0153		-0154	
20	53,0	40,0	19,0	40,0		0,125	-0201		-0202		-0203		-0204	
25	65,0	50,0	25,0	50,0		0,150	-0251		-0252		-0253		-0254	
32	70,0	55,0	31,0	55,0		0,190	-0321		-0322		-0323		-0324	
40	75,0	60,0	37,0	60,0		0,220	-0401		-0402		-0403		-0404	
50	86,0	70,0	49,0	70,0		0,330	-0501		-0502		-0503		-0504	
65	97,0	80,0	66,0	80,0		0,610	-0651		-0652		-0653		-0654	
80	107,0	90,0	81,0	90,0		0,790	-0801		-0802		-0803		-0804	
100	120,0	100,0	100,0	100,0		1,110	-1001		-1002		-1003		-1004	
125	211,0	187,5	125,0	187,5		2,580	-1251		-1252		-1253		-1254	
150	252,0	225,0	150,0	225,0		3,510	-1501		-1502		-1503		-1504	

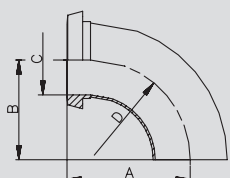

Preis auf Anfrage  
Цена по запросу

**3.07. Bogen mit Anschlüssen, Schweißbogen 180°**

**3.07. Отвод с подключениями, под сварку 180°**

Art.-Nr. 36600-								AISI 304/304L-1.4301/1.4307				AISI 316L-1.4404			
DN	A	B	C	D	E	Gew.	Art.-Nr.	Preis	Art.-Nr.	Preis	Art.-Nr.	Preis	Art.-Nr.	Preis	
mm	mm	mm	mm	mm	mm	kg	poliert	EUR	matt	EUR	poliert	EUR	matt	EUR	
10	39,0	9,0	0,0	26,0		0,180	-0101		-0102		-0103		-0104		
15	48,0	15,0	0,0	35,0		0,220	-0151		-0152		-0153		-0154		
20	53,0	19,0	0,0	40,0		0,370	-0201		-0202		-0203		-0204		
25	65,0	25,0	0,0	50,0		0,535	-0251		-0252		-0253		-0254		
32	70,0	31,0	0,0	55,0		0,650	-0321		-0322		-0323		-0324		
40	75,0	37,0	0,0	60,0		0,755	-0401		-0402		-0403		-0404		
50	86,0	49,0	0,0	70,0		1,000	-0501		-0502		-0503		-0504		
65	97,0	66,0	0,0	80,0		1,835	-0651		-0652		-0653		-0654		
80	107,0	81,0	0,0	90,0		2,650	-0801		-0802		-0803		-0804		
100	120,0	100,0	0,0	100,0		4,100	-1001		-1002		-1003		-1004		
125	211,0	125,0	0,0	187,5		6,080	-1251		-1252		-1253		-1254		
150	252,0	150,0	0,0	225,0		8,660	-1501		-1502		-1503		-1504		

**Bogen KK 90°**

**Отвод ШШ 90°**

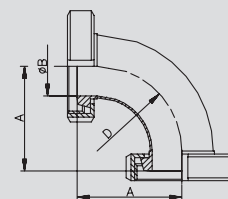

Art.-Nr. 36602-								AISI 304/304L-1.4301/1.4307				AISI 316L-1.4404			
DN	A	B	C	D	E	Gew.	Art.-Nr.	Preis	Art.-Nr.	Preis	Art.-Nr.	Preis	Art.-Nr.	Preis	
mm	mm	mm	mm	mm	mm	kg	poliert	EUR	matt	EUR	poliert	EUR	matt	EUR	
10	38,5	9,0	0,0	26,0		0,177	-0101		-0102		-0103		-0104		
15	44,0	15,0	0,0	35,0		0,208	-0151		-0152		-0153		-0154		
20	48,5	19,0	0,0	40,0		0,357	-0201		-0202		-0203		-0204		
25	59,0	25,0	0,0	50,0		0,520	-0251		-0252		-0253		-0254		
32	62,5	31,0	0,0	55,0		0,570	-0321		-0322		-0323		-0324		
40	66,0	37,0	0,0	60,0		0,740	-0401		-0402		-0403		-0404		
50	74,5	49,0	0,0	70,0		0,970	-0501		-0502		-0503		-0504		
65	83,5	66,0	0,0	80,0		1,660	-0651		-0652		-0653		-0654		
80	90,5	81,0	0,0	90,0		2,340	-0801		-0802		-0803		-0804		
100	102,0	100,0	0,0	100,0		3,515	-1001		-1002		-1003		-1004		
125	170,0	125,0	0,0	187,5		5,090	-1251		-1252		-1253		-1254		
150	202,0	150,0	0,0	225,0		0,000	-1501		-1502		-1503		-1504		

**Bogen KK 45°**

**Отвод ШШ 45°**

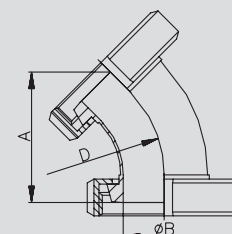

Art.-Nr. 38600-								AISI 304/304L-1.4301/1.4307				AISI 316L-1.4404			
DN	A	B	C	D	E	Gew.	Art.-Nr.	Preis	Art.-Nr.	Preis	Art.-Nr.	Preis	Art.-Nr.	Preis	
mm	mm	mm	mm	mm	mm	kg	poliert	EUR	matt	EUR	poliert	EUR	matt	EUR	
10	52,0	9,0	12,0			0,030	-0101		-0102		-0103		-0104		
15	68,0	15,0	18,0			0,070	-0151		-0152		-0153		-0154		
20	76,0	19,0	22,0			0,100	-0201		-0202		-0203		-0204		
25	100,0	25,0	28,0			0,160	-0251		-0252		-0253		-0254		
32	110,0	31,0	34,0			0,220	-0321		-0322		-0323		-0324		
40	120,0	37,0	40,0			0,280	-0401		-0402		-0403		-0404		
50	140,0	49,0	52,0			0,420	-0501		-0502		-0503		-0504		
65	160,0	66,0	70,0			0,890	-0651		-0652		-0653		-0654		
80	180,0	81,0	85,0			1,220	-0801		-0802		-0803		-0804		
100	200,0	100,0	104,0			1,640	-1001		-1002		-1003		-1004		

**Schweißbogen 180°**

**отвод под сварку 180°**

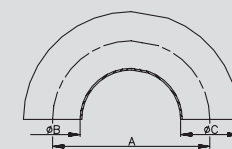

Preis auf Anfrage  
Цена по запросу

### 3.08. Bogen 180°

### 3.08.Отвод 180°

Schweißbogen  
DIN 11852-BS 180°

Art.-Nr. 38620-

AISI 304/304L-1.4301/1.4307

AISI 316L-1.4404

отвод под сварку  
DIN 11852-BS 180°

DN	A mm	B mm	C mm	D mm	E mm	Gew. kg	AISI 304/304L-1.4301/1.4307		AISI 316L-1.4404				
							Art.-Nr. poliert	Preis EUR	Art.-Nr. matt	Preis EUR	Art.-Nr. poliert	Preis EUR	Art.-Nr. matt
10	52,0	10,0	13,0			0,040	-0101		-0102		-0103		-0104
15	70,0	16,0	19,0			0,080	-0151		-0152		-0153		-0154
20	80,0	20,0	23,0			0,110	-0201		-0202		-0203		-0204
25	100,0	26,0	29,0			0,170	-0251		-0252		-0253		-0254
32	110,0	32,0	35,0			0,240	-0321		-0322		-0323		-0324
40	120,0	38,0	41,0			0,300	-0401		-0402		-0403		-0404
50	140,0	50,0	53,0			0,440	-0501		-0502		-0503		-0504

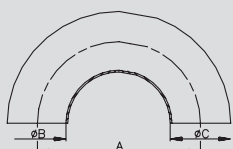

Bogen GG 180°

Art.-Nr. 38700-

AISI 304/304L-1.4301/1.4307

AISI 316L-1.4404

Отвод PP 180°

DN	A mm	B mm	C mm	D mm	E mm	Gew. kg	AISI 304/304L-1.4301/1.4307		AISI 316L-1.4404				
							Art.-Nr. poliert	Preis EUR	Art.-Nr. matt	Preis EUR	Art.-Nr. poliert	Preis EUR	Art.-Nr. matt
10	52,0	9,0	43,0			0,100	-0101		-0102		-0103		-0104
15	68,0	15,0	52,0			0,128	-0151		-0152		-0153		-0154
20	76,0	19,0	59,0			0,210	-0201		-0202		-0203		-0204
25	100,0	25,0	72,0			0,310	-0251		-0252		-0253		-0254
32	110,0	31,0	77,0			0,410	-0321		-0322		-0323		-0324
40	120,0	37,0	82,0			0,530	-0401		-0402		-0403		-0404
50	140,0	49,0	93,0			0,610	-0501		-0502		-0503		-0504
65	160,0	66,0	105,0			1,520	-0651		-0652		-0653		-0654
80	180,0	81,0	115,0			1,970	-0801		-0802		-0803		-0804
100	200,0	100,0	130,0			3,480	-1001		-1002		-1003		-1004

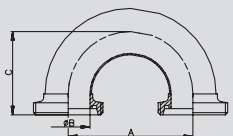

Bogen KK 180°

Art.-Nr. 38900-

AISI 304/304L-1.4301/1.4307

AISI 316L-1.4404

Отвод ШШ 180°

DN	A mm	B mm	C mm	D mm	E mm	Gew. kg	AISI 304/304L-1.4301/1.4307		AISI 316L-1.4404				
							Art.-Nr. poliert	Preis EUR	Art.-Nr. matt	Preis EUR	Art.-Nr. poliert	Preis EUR	Art.-Nr. matt
10	52,0	9,0	39,0			0,186	-0101		-0102		-0103		-0104
15	68,0	15,0	48,0			0,228	-0151		-0152		-0153		-0154
20	76,0	19,0	53,0			0,400	-0201		-0202		-0203		-0204
25	100,0	25,0	65,0			0,510	-0251		-0252		-0253		-0254
32	110,0	31,0	70,0			0,755	-0321		-0322		-0323		-0324
40	120,0	37,0	75,0			0,920	-0401		-0402		-0403		-0404
50	140,0	49,0	86,0			1,150	-0501		-0502		-0503		-0504
65	160,0	66,0	97,0			2,210	-0651		-0652		-0653		-0654
80	180,0	81,0	107,0			3,160	-0801		-0802		-0803		-0804
100	200,0	100,0	120,0			5,720	-1001		-1002		-1003		-1004

